

<b>PLANTA</b>	SUPERFICIE UTIL	98.18
	CONSTRUIDA CERRADA	113.76
<b>TIPO</b>	ELEM. COMUNES	14.90
	TOTAL SUP.CONST. + ELEM.COM.	128.66
	TERRAZA ATICO / DESCUBIERTA	50.47
<b>ATICO</b>		
<b>AT-A</b>		

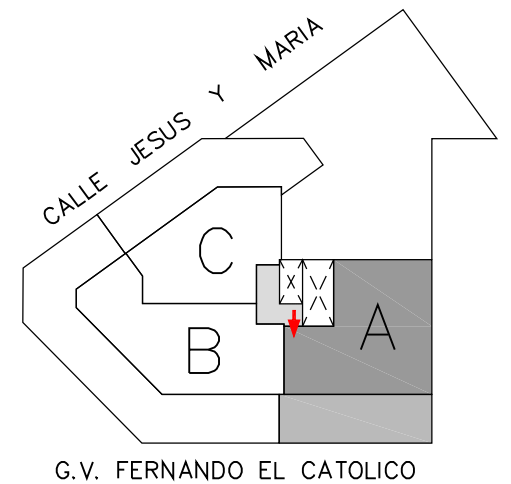

G.V. FERNANDO EL CATOLICO

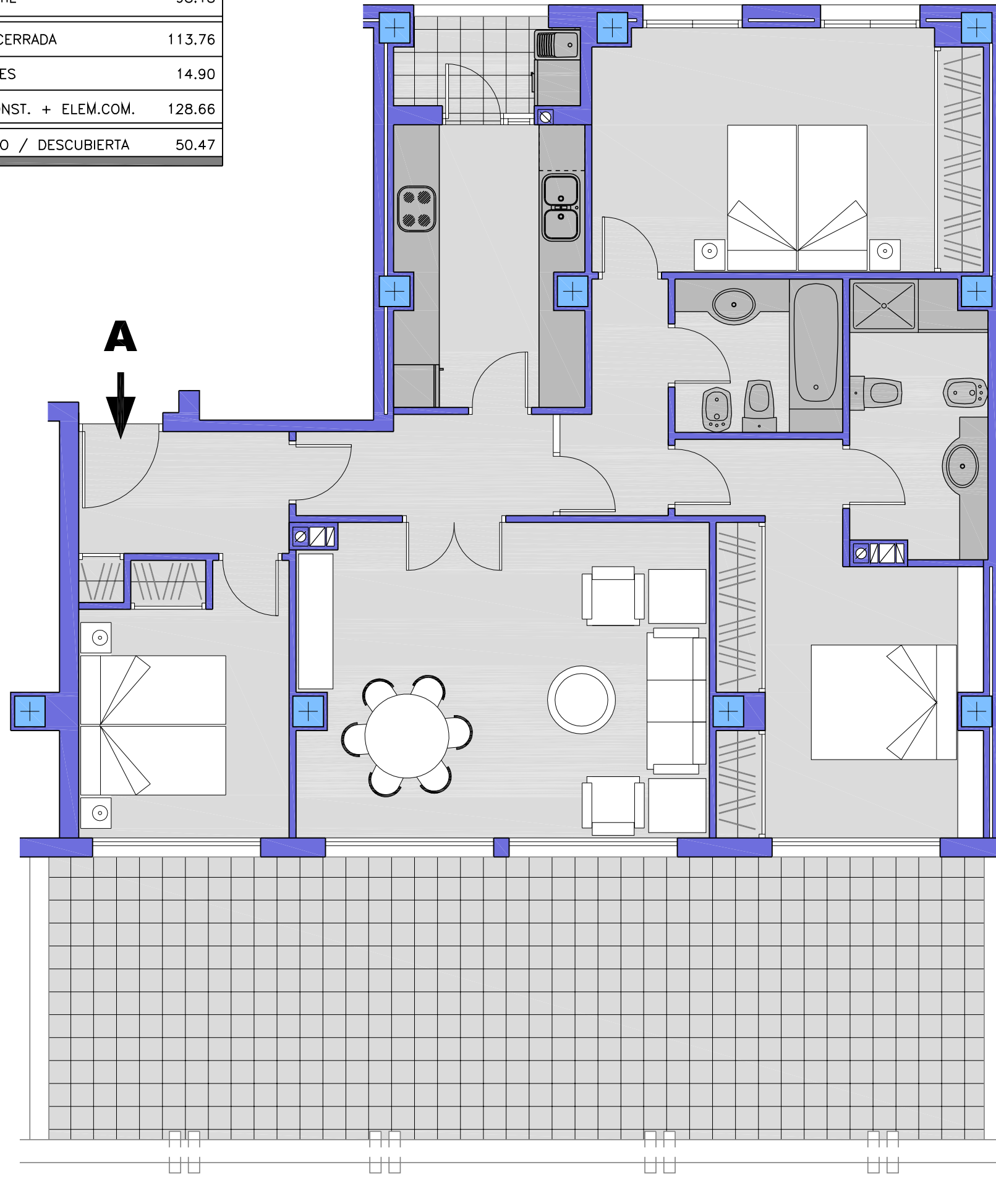